

## FEATURES

- Compatible with both conventional and addressable systems
- Allows siting of fire alarm panel to an alternative location
- Large 21.5" LCD display
- Sleek unobtrusive design
- Displays active fire zones during an alarm condition without user intervention
- User configured media display
- Built-in fault output for monitoring
- Smart power saving mode conserves battery power during a mains failure
- Remote key switch test facility

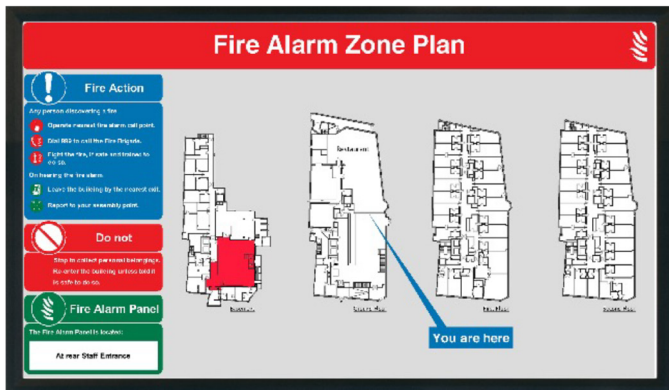

## DESCRIPTION

**dynamicZM** is a dynamic zone mimic® compatible with a range of fire alarm control panels, both addressable and conventional. Utilising a 21.5" LCD display, during a fire alarm event **dynamicZM** automatically overrides all media and displays an active fire alarm zone plan, clearly identifying the zone or zones in an alarm condition. Where multiple zones are in an alarm condition, the first zone to be activated (or zone of origin) is identified with a flashing zone boundary. For linked or non-fire zones separate images or messages can be displayed.

Upon the clearing of alarm conditions and a successful reset of the fire alarm system, **dynamicZM** will revert to the user's media display schedule. No user intervention is required at the **dynamicZM** location either for displaying fire alarm zones in alarm or resetting the fire alarm system.

A general fault output is provided to monitor **dynamicZM**. Should the data connection be lost between the fire alarm control panel and **dynamicZM**, the data fault message will be displayed, and the fault output activated. A suitable PSU complete with a fault relay should be used with **dynamicZM**. When the PSU fault relay is activated **dynamicZM** will enter power saving mode to preserve operation via batteries only. In this scenario, the general fault output will also be activated.

A test facility is provided to enable the connection of a remote test switch. Activation of a connected test switch displays the fire alarm zone plan to enable a periodic check of its accuracy, without activation of the main fire alarm system. This displays for 90 seconds before automatically reverting to the user's media display schedule.

**dynamicZM** can be configured on demand by the end user to display their chosen images and silent video media, without the intervention of a fire alarm engineer. Each **dynamicZM** comes with free access to an online media manager dashboard to configure media and schedules ready for local deployment to **dynamicZM** with a mobile device via Wi-Fi.

**dynamicZM** is flush mounted as standard, offering a sleek and unobtrusive design suitable for numerous applications.

## COMPATIBILITY

**dynamicZM** is compatible with a range of conventional and addressable fire alarm panels from:



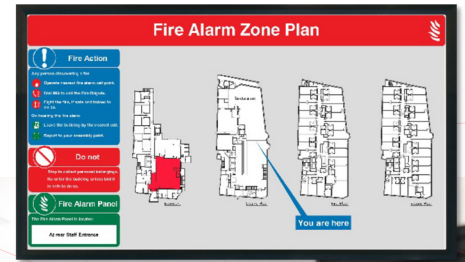

## RETAIL & OFFICES

- Improved shop floor/reception aesthetics
- Fire Alarm panel can be located away from public view
- Clear visual fire indication to customers and visitors
- No limit to media updates

## DESCRIPTION

An ideal solution for improved aesthetic appearance in shops and offices, **dynamicZM** allows for the fire alarm panel to be located away from constant view and possible public interference. In the event of a fire alarm activation, **dynamicZM** will automatically display clear information tailored for your premises, eliminating any confusion for staff, customers, or visitors. With no limit to media updates, your **dynamicZM** can keep up with current retail offers or company sales and marketing messages.

## COMPATIBILITY

**dynamicZM** is compatible with a range of conventional and addressable fire alarm panels from:

